



## The Figaro Shop LED Upgrade Signal Light Kit Fitting Guide



### Parts List:

- 1x LED Replacement Relay
- 2x Front Indicator LED Bulbs
- 2x Side Indicator LED Bulbs
- 2x Rear Indicator LED Bulbs
- 2x Rear Brake/Tail LED Bulbs
- 2x High Level Brake Light LED Bulbs

- 1: 3rd Brake light
- 2: Front Indicator
- 3: Rear Indicator
- 4: Brake/Tail light
- 5: Side indicator
- 6: LED Relay



Here at The Figaro Shop, we pride ourselves at being at the forefront of parts development for the Nissan Figaro and supporting the products we develop. As part of this support (as we understand that we have customers that like to fit their own parts and for our international customers) we have put together several guides illustrating how our parts are fitted.

**PLEASE READ** – this guide is intended to aid in the installation of our products. It is recommended that factory manuals or instructions are followed to remove and re-fit bulbs. Some instructions in this guide are generic. The factory manual should supersede any contradiction.

Most LED bulbs are polarity sensitive. If they do not work, please remove from the bulb holder, and rotate them. Bulb design is subject to change without notice.

## Tools Required:

- Philips Screwdriver
- Flat Bladed Screwdriver
- 2x Cable Ties
- Torch

This guide will show the process of replacing all the signal light bulbs to upgrade them to brighter and more efficient LED units and includes how to change the original flasher/indicator relay for an LED specific item to stop any chances of indicator "hyper flash" (indicators flashing very fast). The guide will show how to change all the bulbs first. This will cause "hyper flash" to begin with and when the relay is changed in the final stages of the guide, the "hyper flash" will stop.

- Remove the front indicator units from the front grille. To do this, rotate the indicator  $\frac{1}{4}$  turn counter clockwise and it will unclip from the grille. Pull out from the grille and rotate the bulb holder  $\frac{1}{4}$  turn to release from the light unit. This will expose the bulb. Remove the bulb by pulling upwards. Push the new LED bulb back into the holder and test using the hazard light switch. If it does not illuminate, remove the bulb, rotate, and try again. Re-fit back into the assembly and back into the grille using the reverse method. If they are tight to re-fit to the grille, the use of a little wd40 on the seal mating to the grill will help.

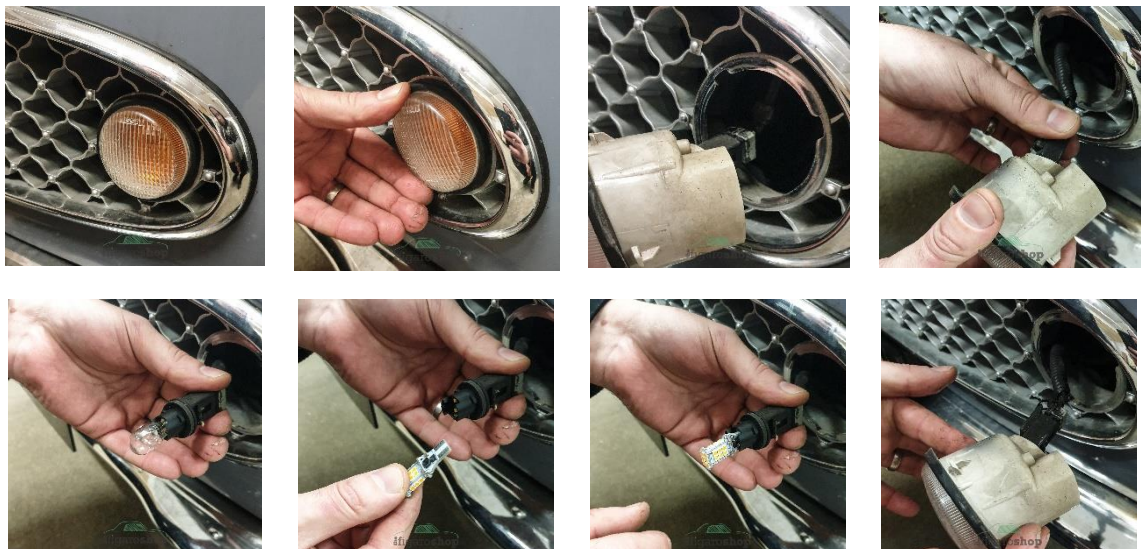

- The next step is to remove the side repeaters / side indicators on the front wings/fenders. The clips for these are relatively loose so you should be able to push the assembly backwards slightly to release from the wing/fender. Once removed from the fender/wing, twist the bulb holder to remove from the indicator. The bulb, as before, will pull out upwards and you are now able to fit the new LED bulb in its place. Check function by using the hazard lights and if it does not illuminate, remove the bulb, rotate, and try again. Re-fit back into the indicator housing, align the front retaining clip of the indicator and clip back into the wing ensuring the rubber seal on the housing is sat correctly.





- Changing the high-level brake light bulbs. There are 2 bulbs in the unit. Open the roof and fold it into the upper boot lid to expose the high-level brake light unit for access. Lever the assembly upwards and towards the front of the car and it will unclip from its base. On the underside of the assembly is a small electrical connector. Unplug this to make access to the bulbs easier. Once removed from the vehicle, rotate each bulb holder ¼ turn to unclip from the housing to expose the bulb. As before, pull the bulb out of the holder and replace both with the new LED bulb. Re-connect to test they work. If not, remove the bulb, rotate, and test again. Re-fit the bulb holders back into the housing and re-fit. Ensure the male centre pin on the assembly aligns with its female counterpart and clip back onto the vehicle.

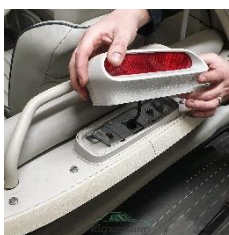
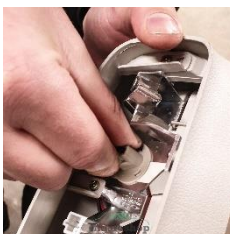

- Open the lower boot/trunk using the key and use the boot stay to keep the lower boot/trunk open. You can access both the indicator/flasher and brake/taillight bulbs from the back of each rear light housing from this area. Putting your hand onto the back of each unit, feel for the bulb holder and rotate it ¼ turn to release from each light housing. There is enough wire to be able to pull the bulb and holder to the open boot area. Both the indicator/flasher and brake/tail bulb have a bayonet base. Simply push and twist to release. They are “offset pin” bulbs so no need to worry about getting them the wrong way.

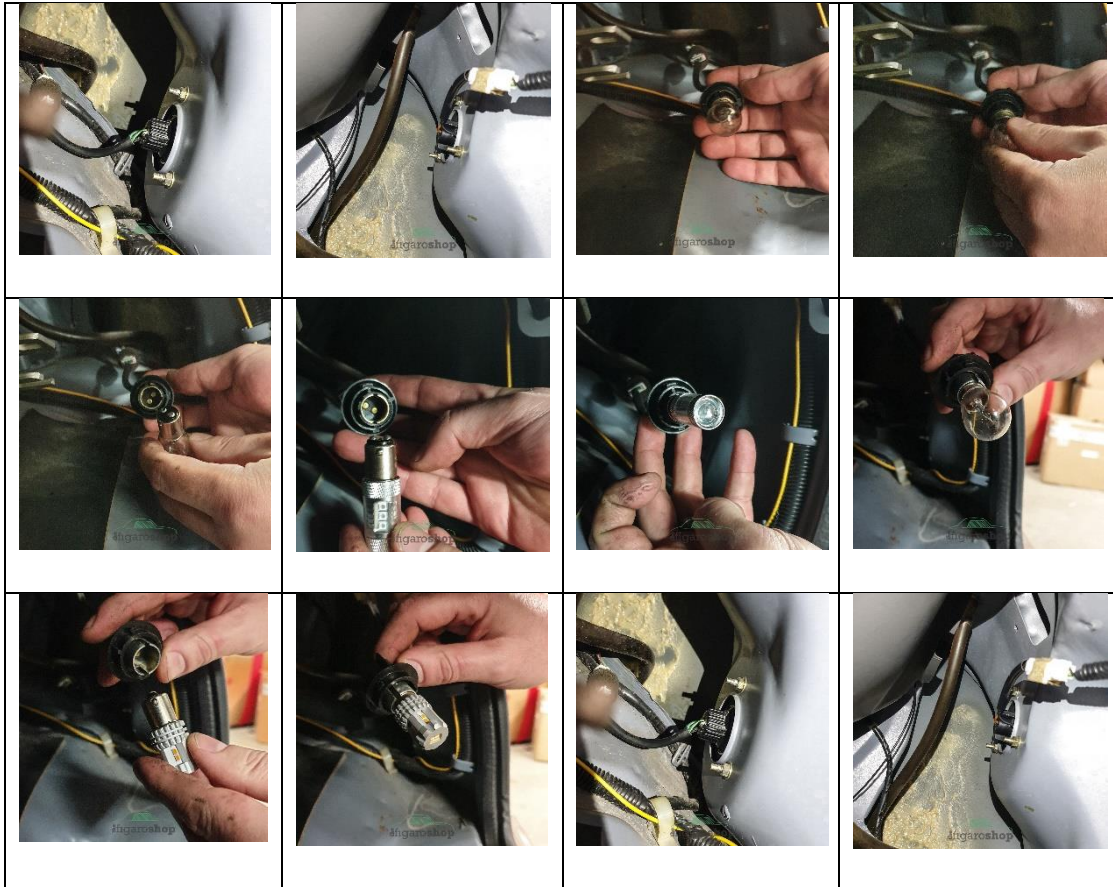

***All 10 bulbs are now changed and tested. You will notice that if, when using the indicators, the bulbs flash at “double time.” This is due to the flasher relay that is included in the kit and will require changing. Out of all the steps, this one is the most complicated and may take around 20 mins or so as the relay is a little tricky to access. The relay is located on the left of the steering column support up high. The original relay does not need removing from the vehicle but will require unplugging so it can be plugged into the new LED relay. To gain access and to be able to see it clearly, we recommend removing both clocks, the steering column surround, and the lower air vent pipe. The steps below will show exactly how to do that.***



- Firstly, remove the ivory-coloured steering column surround. This is simple and requires the use of a Philips/cross head screwdriver. There are 5 screws in total. Unscrew and split the upper from the lower half of the surround and place to one side.



- Next step is to remove both speedometer and rev counter from the dash. This does not gain access to the relay but will help identify its location and will allow you to place a light/torch in there to help locate and unplug it from under the dash. This step is not 100% necessary but may help if doing it for the first time.

Remove both chrome surrounds from the rev/speedo carefully using a thin flat bladed screwdriver. There are 3 clips on each and by applying gentle pressure, they will unclip. Once both are off, set to one side and starting with the rev counter, you will see 3 Philips/cross head screws. Unscrew and gently pull the rev counter from the dash fascia. There is no need to unplug anything. Once removed, place your hand behind the speedometer and feel for the speedo cable. This is a simple clip-on assembly and by pressing the top of the clip, you will be able to pull the cable off the speedometer unit. As before, unscrew the 3 screws and remove from the fascia. Again, no need to unplug anything.

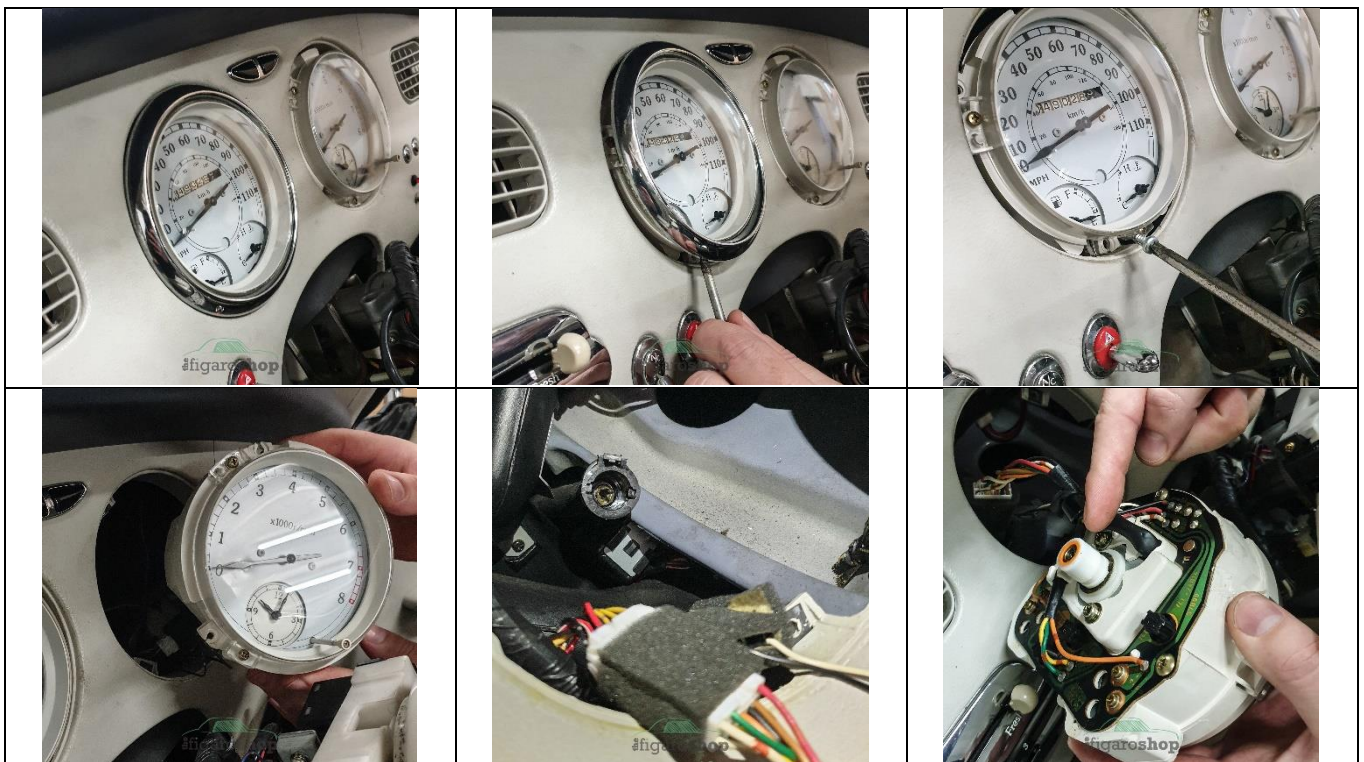

- The next step is to remove the upwards heater vent pipe. This is in the drivers footwell to the left of the brake pedal and is held on with one plastic screw clip. Simply unscrew using a Philips/cross head screwdriver and pull the clip from the pipe. Lying down in the footwell facing up, pull the black vent pipe downwards out of its counterpart. Removing this will help gain access to the relay.



***Taking pictures of the relay's location is a little difficult but with the speedometer out of the fascia, you will be able to see its retaining bracket. The plug for the relay is attached to the rear of the relay unit. For the purposes of the "how to guide" we have taken pictures of a vehicle with a dashboard out to help identify and assist with the next steps.***

- Lying in the drivers footwell and looking up, have a torch placed in the dash fascia where the speedometer was attached to shine a light to help locate the flasher relay. The relay is attached to the steering column support on the left side and has a 3-pin plug clipped into it. You are only interested in the plug. On the plug itself, there will be a little push down tab. Push this tab and pull the plug from the relay. The relay can stay affixed to the column and will not be re-used.





- Once unplugged, you will need to gain access to the plug lower down to be able to plug in the new relay. The wiring loom for the original relay is attached to the column support with a tiny cable clip. Using either a screwdriver or by pulling it down with short sharp force, the loom will un-attach and you will be able to gain access to it near the brake pedal.

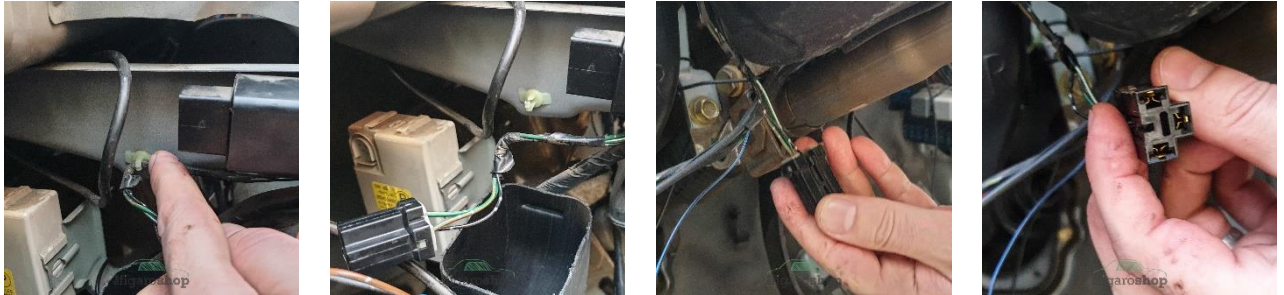

- Once you have access to the plug, simply plug the new LED relay into the original plug. This is a great time to test its operation by indicating both left and right using the indicator stalk. The bulbs should now flash as a normal/slower rate. Once checked, either tape the plug and relay together using electrical tape or pass a cable tie around the relay and plug to secure it. Use a long cable tie to secure the plug to the relay and a short cable tie for the relay to secure to the wiring loom under the dash area away from any moving parts to secure it. Re-assemble the lower vent pipe by pushing it up into its counterpart first and the onto the lower feed securing it with the clip you removed a few stages ago. Re-assemble the speedometer, rev counter and steering column surround in the opposite method.



Congratulations on a successful install and we hope this How to Guide has been helpful installing and upgrading your Figaro to modern high visibility LED's.